

NOTICE!!

These documents have been scanned!

Do not place un-scanned documents beneath this notice!

Do not remove this notice from this file!

GPO Jacket No. 560-102
Print Order 61540
Rise Business Services, LLC
Job=AZ15 6/6/2019



Box Number= AZ15125



Claim Begin-End: AMC427389-AMC427389

1 Initial Receipt



AZ15125-19

AMC356595-AMC427389

United States Department of the Interior
Bureau of Land Management
 LANDS/RECREATION & PLANNING
 ONE N CENTRAL AVE
 PHOENIX, AZ 85004 -2203
 Phone: 602-417-9200

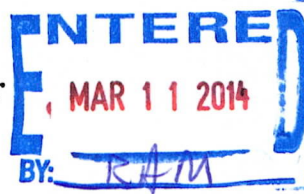

Receipt

No: 2976505

Transaction #: 3065030	
Date of Transaction: 02/25/2014	
CUSTOMER:	
TED & SHEILA BIGELOW PO BOX 448 KIRKLAND, AZ 86332-0448 US	

LINE #	QTY	DESCRIPTION	REMARKS	UNIT PRICE	TOTAL
1	1.00	LOCATABLE MINERALS / MINING CLAIMS-NEW, UNADJUD, ONE OR MORE AUTH NOS / NEW MINING CLAIM LOCATION FEE \$34 CASES: AMC427389/\$34.00		- n/a -	34.00
2	1.00	LOCATABLE MINERALS / MINING CLAIMS-NEW, UNADJUD, ONE OR MORE AUTH NOS / NEW MINING CLAIM PROCESSING FEE CASES: AMC427389/\$20.00		- n/a -	20.00
3	1.00	LOCATABLE MINERALS / MINING CLAIMS-NEW, UNADJUD, ONE OR MORE AUTH NOS / NEW MINING CLAIM MAINT FEE \$140 CASES: AMC427389/\$140.00		- n/a -	140.00
4	1.00	LOCATABLE MINERALS / MINING CLAIMS-NOT NEW-UNADJUD, ONE AUTH NO. ONLY / MINING CLAIM MONEY RECEIVED CASES: AMC427389/\$140.00	NEW ASSOC PLACER	- n/a -	140.00
TOTAL:					\$334.00

PAYMENT INFORMATION			
NOTE: Items will appear on credit card statement as "Bureau of Land Mgmt CO".			
1	AMOUNT:	334.00	POSTMARKED: N/A
	TYPE:	CREDIT CARD	RECEIVED: 02/25/2014
	NAME:	BIGELOW, TED & SHEILA PO BOX 448 KIRKLAND AZ 86332-0448 US	
	CARD NO:	XXXXXXXXXXXX6656	AUTH CODE: 926052
	NAME ON		

CARD:	THEODORE S BEGELOW
EXPIRES:	02/2017
SIGNATURE:	

REMARKS

This receipt was generated by the automated BLM Collections and Billing System and is a paper representation of a portion of the official electronic record contained therein.

NOTICE!!

These documents have been scanned!

Do not place un-scanned documents beneath this notice!

Do not remove this notice from this file!

GPO Jacket No. 560-102
Print Order 61540
Rise Business Services, LLC
Job=AZ15 6/6/2019



Box Number= AZ15125



Claim Begin-End: AMC427389-AMC427389

2 Correspondence



AZ15125-19

AMC356595-AMC427389

**NO
DOCUMENTS
FOUND**

NO DOCUMENTS FOUND
NO DOCUMENTS FOUND

NOTICE!!

These documents have been scanned!

Do not place un-scanned documents beneath this notice!

Do not remove this notice from this file!

GPO Jacket No. 560-102
Print Order 61540
Rise Business Services, LLC
Job=AZ15 6/6/2019



Box Number= AZ15125



Claim Begin-End: AMC427389-AMC427389

3 Transfers



AZ15125-19

AMC356595-AMC427389

Please Return to:
Sheila Bigelow
P.O. Box 1887
Port Angeles, WA 98362

AMC426143
AMC 427389
AMC 433772

QUIT CLAIM DEED

THIS QUIT CLAIM DEED, Executed this 1st Day of November, 2015,

by the following party, hereinafter referred to as GRANTOR,

Names: **Ted Bigelow and Sheila Bigelow**

Whose Address is: **P.O. Box 138
Wittmann, AZ 85361**

To second parties, hereinafter referred to as GRANTEE,

Names: **Larry Jenkins / Byron Caldwell**

Addresses: **2907 23rd Street / 2314 Gunnison Ave.
Snyder, TX 79549 / Grand Junction, CO 81501**

BLM DATE STAMP:

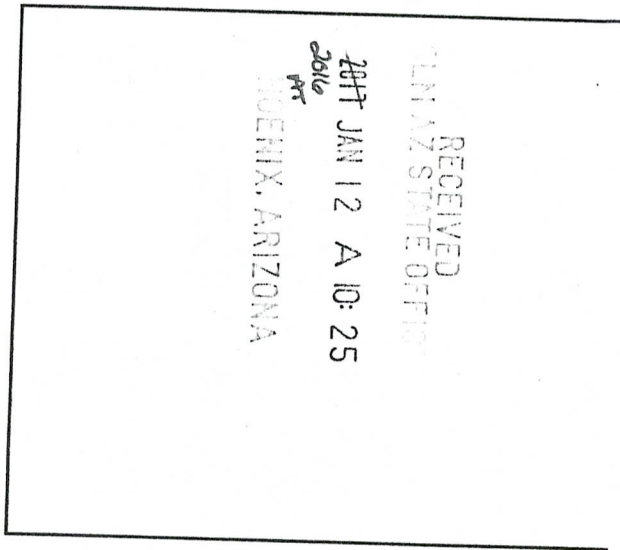

WITNESSETH, That the said GRANTOR, for valuable consideration by the GRANTEE, the sufficiency and receipt of which is hereby acknowledged, does hereby remise, release and quitclaim unto the said GRANTEE forever, all the right, title, interest, and claim which the said GRANTOR has in and to the following described **40 acre** mining claim, and improvements and appurtenances thereto in the County of: **Maricopa**, State of: **Arizona**, to wit:

40 ACRE
MINING CLAIM: AMC426144; Pharaoh's Gold

NO TRANSFER FEE NECESSARY
EXEMPT PER ARS 11-1134 A-6

3472741

ENTERED INTO COMPUTER
11/22/2016 DJG

When recorded,
Please Return to:

Sheila Bigelow
P.O. Box 1887
Port Angeles, WA 98362

QUIT CLAIM DEED

THIS QUIT CLAIM DEED, Executed this 1st Day of November, 2015,

by the following party, hereinafter referred to as GRANTOR,

Names: **Ted Bigelow and Sheila Bigelow**

Whose Address is: **P.O. Box 138
Wittmann, AZ 85361**

To second parties, hereinafter referred to as GRANTEE,

Name: **Pete Lance AND Christy Stegner**

Whose Address Is: **10617 W. Daley Lane
Peoria, AZ 85383**

BLM DATE STAMP:

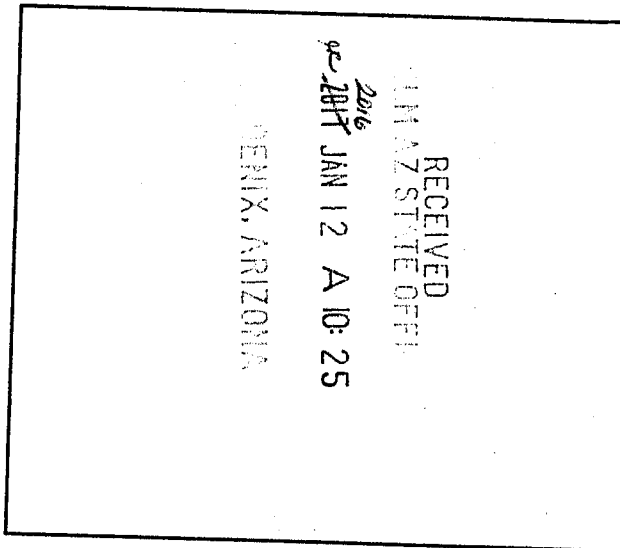

WITNESSETH, That the said GRANTOR, for valuable consideration by the GRANTEE, the sufficiency and receipt of which is hereby acknowledged, does hereby remise, release and quitclaim unto the said GRANTEE forever, all the right, title, interest, and claim which the said GRANTOR has in and to the following described **40 acre** mining claim, and improvements and appurtenances thereto in the County of: **Maricopa**, State of: **Arizona**, to wit:

40 ACRE
MINING CLAIM: AMC427389; Tub O' Gold

NO TRANSFER FEE NECESSARY
EXEMPT PER ARS 11-1134 A-6

Please Return to:

Sheila Bigelow
P.O. Box 1887
Port Angeles, WA 98362

QUIT CLAIM DEED

THIS QUIT CLAIM DEED, Executed this 30th Day of December, 2015,

by the following party, hereinafter referred to as GRANTOR,

Names: **Sheila Bigelow**

Whose Address is: **P.O. Box 138
Wittmann, AZ 85361**

To second parties, hereinafter referred to as GRANTEE,

Name: **Doug Cooper**

Whose Address is: **15069 N. 114th Way
Scottsdale, AZ 85255**

BLM DATE STAMP:

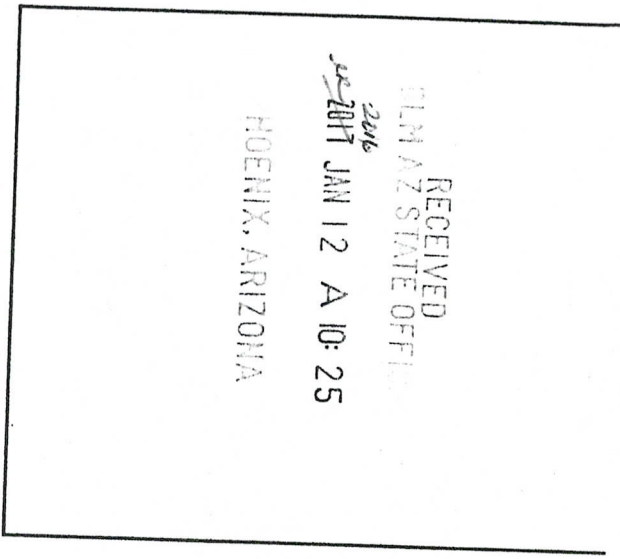

WITNESSETH, That the said GRANTOR, for valuable consideration by the GRANTEE, the sufficiency and receipt of which is hereby acknowledged, does hereby remise, release and quitclaim unto the said GRANTEE forever, all the right, title, interest, and claim which the said GRANTOR has in and to the following described **20 acre** mining claim, and improvements and appurtenances thereto in the County of: **Maricopa**, State of: **Arizona**, to wit:

20 ACRE
MINING CLAIM: AMC433772; Gold Flow #1

**NO TRANSFER FEE NECESSARY
EXEMPT PER ARS 11-1134 A-6**

When recorded,
Please Return To:

Sheila Bigelow
P.O. Box 1887
Port Angeles, WA 98362

QUIT CLAIM DEED

THIS QUIT CLAIM DEED, Executed this 30th Day of December, 2015,

by the following party, hereinafter referred to as GRANTOR,

Names: **Sheila Bigelow**

Whose Address is: **P.O. Box 138
Wittmann, AZ 85361**

To second parties, hereinafter referred to as GRANTEE,

Name: **William O. Young**

Whose Address Is: **3338 Laurel Crest Dr.
Kingwood, TX 77339-2245**

BLM DATE STAMP:

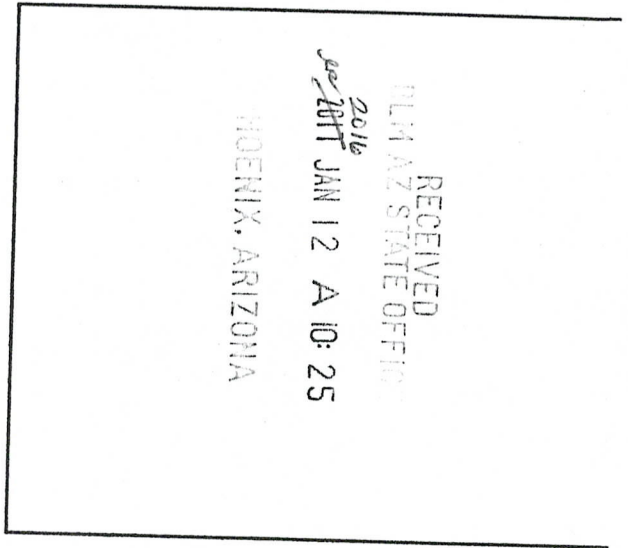

WITNESSETH, That the said GRANTOR, for valuable consideration by the GRANTEE, the sufficiency and receipt of which is hereby acknowledged, does hereby remise, release and quitclaim unto the said GRANTEE forever, all the right, title, interest, and claim which the said GRANTOR has in and to the following described **20 acre** mining claim, and improvements and appurtenances thereto in the County of: **Maricopa**, State of: **Arizona**, to wit:

20 ACRE
MINING CLAIM: AMC433773; Golden Glow #3

**NO TRANSFER FEE NECESSARY
EXEMPT PER ARS 11-1134 A-6**

United States Department of the Interior
Bureau of Land Management
 LANDS/RECREATION & PLANNING
 ONE N CENTRAL AVE
 PHOENIX, AZ 85004 -2203
 Phone: 602-417-9200

Receipt

No: 3472741

Transaction #: 3572748	
Date of Transaction: 01/12/2016	
CUSTOMER:	
SHEILA BIGELOW PO BOX 138 WITTMANN,AZ 85361-0138 US	

LINE #	QTY	DESCRIPTION	REMARKS	UNIT PRICE	TOTAL
1	1.00	LOCATABLE MINERALS / MINING CLAIMS- NOT NEW-UNADJUD,ONE AUTH NO. ONLY / MINING CLAIM MONEY RECEIVED CASES: AMC426144/\$60.00	TRF/6	- n/a -	60.00
TOTAL:					\$60.00

PAYMENT INFORMATION			
NOTE: Items will appear on credit card statement as "Bureau of Land Mgmt CO".			
1	AMOUNT:	60.00	POSTMARKED: N/A
	TYPE:	CREDIT CARD	RECEIVED: 01/12/2016
	NAME:	BIGELOW, SHEILA PO BOX 138 WITTMANN AZ 85361-0138 US	
	CARD NO:	XXXXXXXXXXXX6656	AUTH CODE: 488480
	NAME ON CARD:	THEODORE S BIGELOW	
	EXPIRES:	02/2018	
	SIGNATURE:		

REMARKS

This receipt was generated by the automated BLM Collections and Billing System and is a paper representation of a portion of the official electronic record contained therein.

NOTICE!!

These documents have been scanned!

Do not place un-scanned documents beneath this notice!

Do not remove this notice from this file!

GPO Jacket No. 560-102
Print Order 61540
Rise Business Services, LLC
Job=AZ15 6/6/2019



Box Number= AZ15125



Claim Begin-End: AMC427389-AMC427389

4 Annual Filings



AZ15125-19

AMC356595-AMC427389

DEPARTMENT OF THE INTERIOR
BUREAU OF LAND MANAGEMENT
MINING CLAIMS

Run Date/Time: 9/11/2018

MC Maintenance Fees Paid Through the BLM Pay Portal
(by Date Paid)

Page 671 Of 723

CBS Receipt: 4252569

Printed For Lead File # AMC427389

Agency Tracking ID: 1535759116

Assessment Year: 2019

Paid On: 9/1/2018

Number of BLM Serial Nr: 1

Total Amount Paid: \$310.00

Claim Name	BLM Serial No	Lead File No	Amount Paid
TUB O GOLD	AMC427389	AMC427389	\$310.00

United States Department of the Interior
Bureau of Land Management
 BUSINESS & SUPPORT SVCS DIV
 ONE N CENTRAL AVE SUITE 800
 PHOENIX, AZ 85004 -4427
 Phone: 602-417-9200

Receipt

No: 4252569

Transaction #: 4368086	
Date of Transaction: 08/31/2018	
CUSTOMER:	
PETE LANCE 10617 W DALEY LN PEORIA, AZ 85383 US	

LINE #	QTY	DESCRIPTION	REMARKS	UNIT PRICE	TOTAL
1	1.00	LOCATABLE MINERALS / MINING CLAIMS-NOT NEW-UNADJUD, ONE AUTH NO. ONLY / MINING CLAIM MONEY RECEIVED CASES: AMC427389/\$310.00		- n/a -	310.00
TOTAL:					\$310.00

PAYMENT INFORMATION			
NOTE: Items will appear on credit card statement as "BLM O Mining Claim".			
1	AMOUNT:	310.00	POSTMARKED: N/A
	TYPE:	CREDIT CARD	RECEIVED: 08/31/2018
	NAME:	PETE LANCE 10617 W DALEY LN PEORIA AZ 85383 US	
	CARD NO:	XXXXXXXXXXXX4343	AUTH CODE: 104379
	NAME ON CARD:	PETE LANCE	
	SIGNATURE:		

REMARKS

This receipt was generated by the automated BLM Collections and Billing System and is a paper representation of a portion of the official electronic record contained therein.

Run Date: 09/05/17

Run Time: 02:33 PM

**DEPARTMENT OF THE INTERIOR
BUREAU OF LAND MANAGEMENT
MINING CLAIMS**

MC Maintenance Fees Paid Through the BLM Pay Portal

CBS Receipt: 3969950

Printed For Lead File # AMC427389

Agency Tracking ID: 1504282182

Number of BLM Serial Nr: 2

Assessment Year: 2018, 2019

Paid On: 09/01/2017

Total Amount Paid: \$620.00

Claim Name	BLM Serial No	Lead File No	Amount Paid
TUB O GOLD	AMC427389	AMC427389	\$620.00

United States Department of the Interior
Bureau of Land Management
 BUSINESS & SUPPORT SVCS DIV
 ONE N CENTRAL AVE SUITE 800
 PHOENIX, AZ 85004 -4427
 Phone: 602-417-9200

Receipt

No: 3969950

Transaction #: 4079862	
Date of Transaction: 09/01/2017	
CUSTOMER:	
PETE LANCE 10617 W DALEY LN PEORIA, AZ 85383 US	

LINE #	QTY	DESCRIPTION	REMARKS	UNIT PRICE	TOTAL
1	1.00	LOCATABLE MINERALS / MINING CLAIMS- NOT NEW-UNADJUD, ONE AUTH NO. ONLY / MINING CLAIM MONEY RECEIVED CASES: AMC427389/\$310.00		- n/a -	310.00
TOTAL:					\$310.00

PAYMENT INFORMATION			
NOTE: Items will appear on credit card statement as "BLM O Mining Claim".			
1	AMOUNT:	310.00	POSTMARKED: N/A
	TYPE:	CREDIT CARD	RECEIVED: 09/01/2017
	NAME:	PETE LANCE 10617 W DALEY LN PEORIA AZ 85383 US	
	CARD NO:	XXXXXXXXXXXX8053	AUTH CODE: 091111
	NAME ON CARD:	PETE LANCE	
	EXPIRES:	04/2021	
	SIGNATURE:		

REMARKS

This receipt was generated by the automated BLM Collections and Billing System and is a paper representation of a portion of the official electronic record contained therein.

427389

MAINTENANCE FEE PAYMENT

Claimant Name: Pete Lance
Address: 10617 W. Daley Ln.
City: Peoria State: AZ Zip: 85383
Telephone: 602 413-5163
E-mail address: Petelance@hotmail.com
Signature: Pete Lance

RECEIVED
BLM AZ STATE OFFICE
2016 AUG 25 P 12:41
PHOENIX, ARIZONA
BLM
Date
Stamp

Check here if this is a change of address.

LINE NO.	AMC NUMBER	CLAIM/SITE NAME	COUNTY RECORDER DATA (If available)	TWP	RNG	SEC
1	427389	Tub O'Gold	20140121563	7N	3W	17
2						
3						
4						
5						
6						
7						
8						
9						
10						

List additional claims on Form MCF114. 40 ac.

No. of Claims*: 1 x \$155 = 310
Check No: CC Init. ERG
Receipt No.: 3641097
For BLM Use Only

Bureau of Land Management
Arizona State Office
www.blm.gov/az/

* \$155 per lode mining claim, mill site, or tunnel site; and \$155 for each 20 acres or portion thereof for each placer mining claim.

Form: MCF112
Revised July 2014

This form is available from the **Arizona Geological Survey** and may be reproduced.

ENTERED
AUG 26 2016
BY: RAM

**United States Department of the Interior
Bureau of Land Management
DIV OF LANDS, MINRLS & ENERGY
ONE N CENTRAL AVE
PHOENIX, AZ 85004 -4427
Phone: 602-417-9200**

Receipt

No: 3641097

Transaction #: 3745040	
Date of Transaction: 08/25/2016	
CUSTOMER:	
PETE LANCE 10617 W DALEY LN PEORIA, AZ 85383-1756 US	

LINE #	QTY	DESCRIPTION	REMARKS	UNIT PRICE	TOTAL
1	1.00	LOCATABLE MINERALS / MINING CLAIMS- NOT NEW-UNADJUD, ONE AUTH NO. ONLY / MINING CLAIM MONEY RECEIVED CASES: AMC427389/\$310.00	2017 MAINT (1)	- n/a -	310.00
TOTAL:					\$310.00

PAYMENT INFORMATION			
NOTE: Items will appear on credit card statement as "Bureau of Land Mgmt CO".			
1	AMOUNT:	310.00	POSTMARKED: N/A
	TYPE:	CREDIT CARD	RECEIVED: 08/25/2016
	NAME:	LANCE, PETE 10617 W DALEY LN PEORIA AZ 85383-1756 US	
	CARD NO:	XXXXXXXXXXXX8053	AUTH CODE: 024120
	NAME ON CARD:	PETE G LANCE	
	EXPIRES:	01/2018	
	SIGNATURE:		

REMARKS

This receipt was generated by the automated BLM Collections and Billing System and is a paper representation of a portion of the official electronic record contained therein.

MAINTENANCE FEE PAYMENT FORM

Remitters

Ted & Sheila Bigelow
P.O. Box 138
Wittmann, AZ 85361
602-471-3470

synbigelows@earthlink.net

Maintenance Fee for the 2016 assessment year

401292
416265
426091
426143
427389
430531

Placer Claims

- 1) AMC401293 --- Jubilation #1 -----7N 3W Sec. 18&19 - 60 acres --- \$465.00
- 2) AMC416266 --- Rainbows End #11 -----7N 3W Sec. 7 -----39.09 acres --- \$310.00
- 3) AMC426091 --- Pharaohs Tomb #9 -----7N 3W Sec. 18 ----- 40 acres--- \$310.00
- 4) AMC426144 --- Pharaoh's Gold -----7N 3W Sec. 18 ----- 40 acres --- \$310.00
- 5) AMC427389 --- Tub O Gold -----7N 3W Sec. 17 ----- 40 acres --- \$310.00
- 6) AMC430532 --- Golden Sunset #2 -----6N 3W Sec. 5 ----- 20 acres --- \$155.00

TOTAL MAINTENANCE FEE PAYMENT ----- \$1,860.00

*Sheila Bigelow
T Bigelow*

RECEIPT # 3384031

RECEIVED
PLM & SERVICE
2015 AUG 31 P 3:48
PHOENIX, ARIZONA

ENTERED
SEP 02 2015
BY: *gl*

Shella Digelow

P.O. Box 138

Wittmann, AZ 85361

RECEIVED
BLM AZ STATE OFFICE

2015 AUG 31 P 3:48

PHOENIX, ARIZONA

Bureau of Land Management
Arizona State Office
One North Central Avenue
Suite 800
Phoenix, AZ 85004-4427

PRESS FIRMLY TO SEAL

PRESS FIRMLY TO SEAL

PRIORITY MAIL
POSTAGE REQUIRED

PRIORITY MAIL



Retail

P

US POSTAGE PAID
\$5.75

Origin: 98362
Destination: 85004

002.30 oz

Aug 28, 15

6486920354-06

1006

PRIORITY MAIL® 2-DAY

RECEIVED
BLM AZ STATE OFFICE
WH
LA
2015 AUG 31 P
PHOENIX, ARIZ

Expected Delivery Day: 08/31/15

USPS TRACKING NUMBER

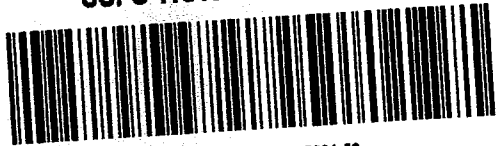

9505 5110 1393 5240 5631 53

FRC



PRIORITY MAIL

For Domestic
and International Use

UNITED STATES POSTAL SERVICE

Ted Bigelow
From P.O. Box 135
Wittmann, AZ 85361



TO Bureau of Land Management
Arizona State Office
One North Central Avenue
Suite 800
Phoenix, AZ 85004-4427

Label 228, January 2008



PS00001000014

EP14F July 2013
OD: 12.5 x 9.5

VISIT US AT USPS.COM®
ORDER FREE SUPPLIES ONLINE



This packaging is the property of the U.S. Postal Service® and is provided solely for use in sending Priority Mail® shipments. Misuse may be a violation of federal law. This packaging is not for resale. EP14F © U.S. Postal Service, July 2013. All rights reserved.

United States Department of the Interior
Bureau of Land Management
LANDS/RECREATION & PLANNING
ONE N CENTRAL AVE
PHOENIX, AZ 85004 -2203
Phone: 602-417-9200

Receipt

No: 3384031

Transaction #: 3482356	
Date of Transaction: 09/01/2015	
CUSTOMER:	
TED & SHEILA BIGELOW PO BOX 138 WITTMANN, AZ 85361-0138 US	

LINE #	QTY	DESCRIPTION	REMARKS	UNIT PRICE	TOTAL
1	1.00	LOCATABLE MINERALS / MINING CLAIMS- NOT NEW-UNADJUD, ONE AUTH NO. ONLY / MINING CLAIM MONEY RECEIVED CASES: AMC401293/\$1860.00	MAINT FEE PYMNT - 6 2016	- n/a -	1860.00
TOTAL:					\$1,860.00

PAYMENT INFORMATION					
1	AMOUNT:	1860.00	POSTMARKED:	08/28/2015	
	TYPE:	CHECK	RECEIVED:	08/31/2015	
	CHECK NO:	214			
	NAME:	BIGELOW, THEODORE 18698 S JOSEPH HODGE RD PEEPLS VALLEY AZ 86332 US			

REMARKS

This receipt was generated by the automated BLM Collections and Billing System and is a paper representation of a portion of the official electronic record contained therein.

ENTERED
SEP 02 2015
BY: *JK*

NOTICE!!

These documents have been scanned!

Do not place un-scanned documents beneath this notice!

Do not remove this notice from this file!

GPO Jacket No. 560-102
Print Order 61540
Rise Business Services, LLC
Job=AZ15 6/6/2019



Box Number= AZ15125



Claim Begin-End: AMC427389-AMC427389

5 Miscellaneous



AZ15125-19

AMC356595-AMC427389

**NO
DOCUMENTS
FOUND**

NO DOCUMENTS FOUND
NO DOCUMENTS FOUND

NOTICE!!

These documents have been scanned!

Do not place un-scanned documents beneath this notice!

Do not remove this notice from this file!

GPO Jacket No. 560-102
Print Order 61540
Rise Business Services, LLC
Job=AZ15 6/6/2019



Box Number= AZ15125



Claim Begin-End: AMC427389-AMC427389

6 Location Notices-Amendments and Supporting Documents



AZ15125-19

AMC356595-AMC427389

CLAIM STATUS REPORT

Data Entered: 03/11/14 Ram

MTP Checked By: Ac 03/11/14 RAM

GEO Checked By: Ac 03/11/14 RAM

LEAD SERIAL NUMBER: AMC 427389 thru AMC _____

NUMBER OF CLAIMS & TYPE:

- _____ LODGE
- _____ PLACER
- 1 ASSOCIATION PLACER
- _____ MILL SITE
- _____ TUNNEL SITE

CHARGES:

Location Fee @ \$34 = \$ 34

Processing Fee @ \$20 = \$ 20

Maintenance Fee @ \$140 = \$ 140

Add'l Maint Fee for Assoc Placer = \$ 140

SUBTOTAL \$ _____

Other Fees \$ _____

Other Fees \$ _____

TOTAL \$ 334

TOTAL ACREAGE: 40 Per Claim
(Placer Only)

NUMBER OF LOCATORS: 2

DOCUMENTS RECEIVED VIA: Over-the-Counter Mail TIMELY FILED: Yes No

LEGAL DESCRIPTION: T 07N R 03W SEC 017

T _____ R _____ SEC _____

T _____ R _____ SEC _____

T _____ R _____ SEC _____

T _____ R _____ SEC _____

BLM FOREST SERVICE SUBJ TO PL 359: Yes No
WILDERNESS AREA

SPLIT ESTATE: N/A SX PX OTHER
SRHA Was proper Notice filed if located on SHRA Land? Yes No

RECONVEYED MINERALS ON BLM LAND REQUIRE OPENING ORDER FROM 1944 TO 1993:

Open to Entry On _____ N/A

COMMENTS/STATUS: VOID PARTIALLY VOID PVT MINERALS WITHDRAWN LANDS
OTHER

AMC427389

Claimant acknowledges that portions of the following claim(s) site(s) may be void or voidable.

Printed Name of Claimant _____ Signature of Claimant _____

*****FINAL ADJUDICATION*****

DATE 6/24/14 INITIALS AT

LOCATION NOTICE FOR LODE MINING CLAIM

NOTICE IS HEREBY GIVEN that the Tub o' Gold lode mining claim has been located by Ted & Sheila Bigelow P.O. Box 448, Kirkland, AZ, 86332

The general course of this claim is Square and it is situated in Maricopa County(ies), Arizona.

This claim is 1,320' feet in length and 1,320' feet in width. This claim runs from the location monument on which the location notice is posted approximately 1,320 feet in a N direction to the N end line and 1,320 feet in a E direction to the E end line. This claim is marked by seven monuments, one at each corner, two at each end center, and one location monument.

The location monument on which this notice is posted is situated within Section 17, Township 7 N, Range 3 W, Gila Salt River Base and Meridian, Arizona. This claim encompasses portions of the following legal subdivision(s) if located by legal subdivision or the following quarter section(s), Section(s), Township(s), and Range(s): SW 1/4 NW 1/4 Sec. 17, T 7N R 3W, Gila Salt River Base and Meridian, Arizona.

The locality of this claim with reference to some natural object or permanent monument and additional information (if any) concerning its locality are as follows: That 40 acres of which the N.W.C. is located 1,320' S. of the N.W.C. of U.S.G.S. Sec. 17, T 7N R 3W

DATED AND POSTED on the ground this 1st day of Dec., 2013.

LOCATOR(s) T Bigelow
Sheila Bigelow

BLM DATE STAMP:

PHOENIX, AZ
RECEIVED
B.L.M. AZ STATE OFFICE
2014 FEB 25 P 3:44

ANON 21389

BLM DATE STAMP:

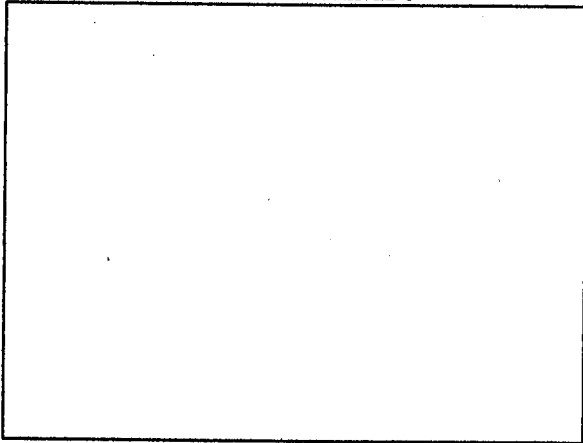

CLAIM MAP



N

Lode () Placer (X)

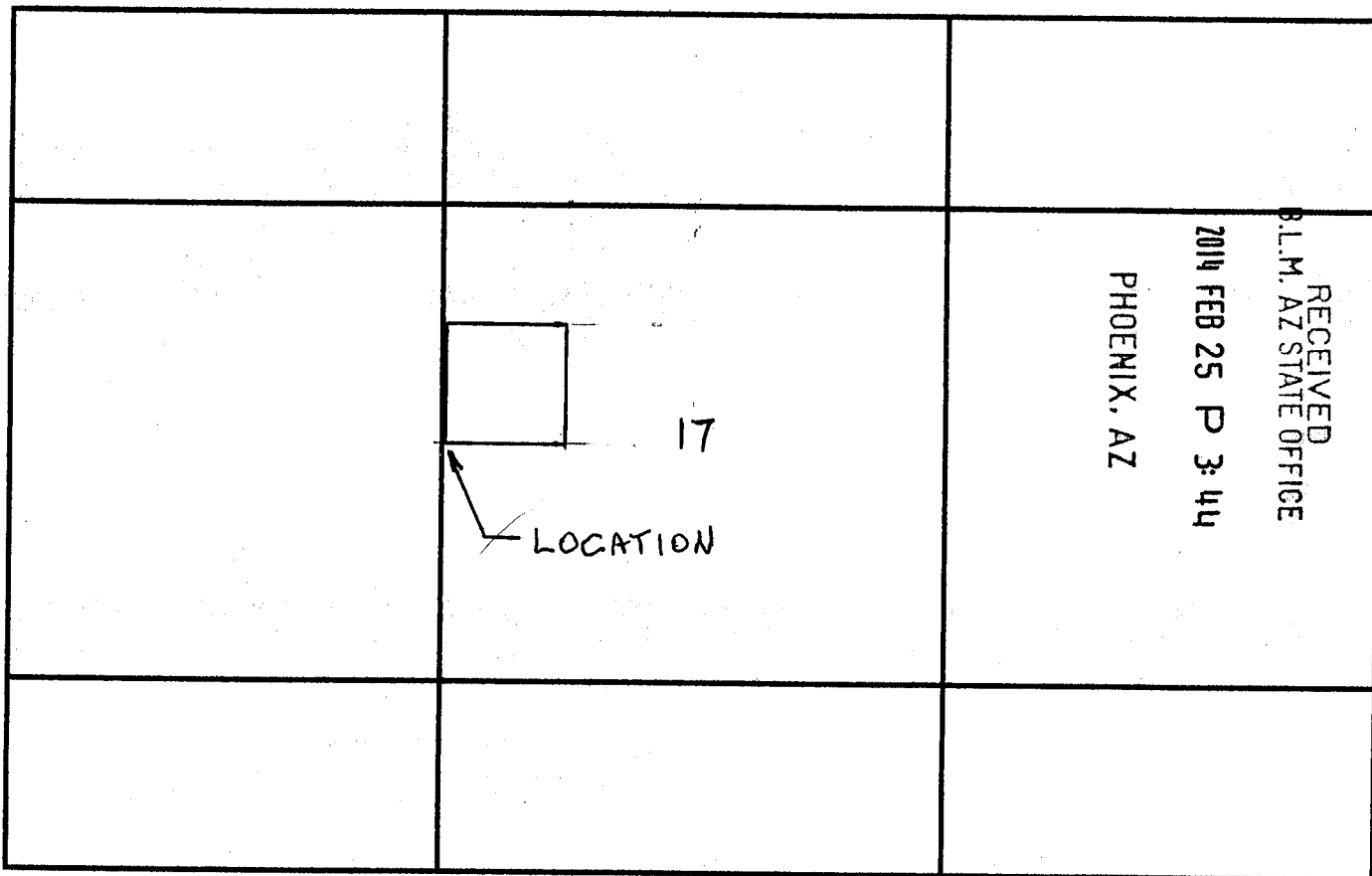

Scale: 1" = _____

1. The above map depicts the Tub o' Gold mining claim, which is located in the SW¹/₄ NW¹/₄ of Section(s) 17, Township 7 N, Range 3 W, Gila and Salt River Base and Meridian, Maricopa County Arizona.

2. The type of corner and location monuments used are as follows: 2" x 4' capped P.V.C.

3. The bearings and distances in degrees and feet between claim corners are as depicted on the map.

NOTE: DRAWING NOT TO SCALE

AHON 27309

DEPARTMENT OF INTERIOR
BUREAU OF LAND MANAGEMENT

Input Parameters for Geographic Report with Land

System Id = CR

Admin State = AZ

Geo State =

Casetype Begins With

Case Disp Txt = AUTHORIZED, CANCELLED, EXPIRED, PENDING, REJECTED, RELINQUISHED, VOID, WITHDRAWN

Mer Twp Rng = 14 0070N 0030W

Section = 017, 999

Mtrs =

Commodity =

Commodity Txt =

Pending Org =

Pend Org Decode =

Total Rows Returned: 5

UNITED STATES DEPARTMENT OF INTERIOR
 BUREAU OF LAND MANAGEMENT
 GEOGRAPHIC REPORT WITH LAND
 Sorted by Meridian Township Range

Adm State: AZ

Serial Number: AZA 024287

Total Case Acres: 1.000

<u>Casetype</u>	<u>Case Disp</u>			<u>Sect</u>	<u>Sur Typ</u>	<u>Sur Num</u>	<u>Suff</u>	<u>Subdivision</u>	<u>Act Pend</u>
380913	EXPIRED	14	0070N	0030W	017	FF	1	PORTION OF;	

Serial Number: AZA 031568

Total Case Acres: 1.000

<u>Casetype</u>	<u>Case Disp</u>			<u>Sect</u>	<u>Sur Typ</u>	<u>Sur Num</u>	<u>Suff</u>	<u>Subdivision</u>	<u>Act Pend</u>
293200	AUTHORIZED	14	0070N	0030W	017	FF		PORTION OF;	

Serial Number: AZA 031961

Total Case Acres: 1.000

<u>Casetype</u>	<u>Case Disp</u>			<u>Sect</u>	<u>Sur Typ</u>	<u>Sur Num</u>	<u>Suff</u>	<u>Subdivision</u>	<u>Act Pend</u>
293200	EXPIRED	14	0070N	0030W	017	FF		PORTION OF;	

Serial Number: AZA 035151

Total Case Acres: 1.000

<u>Casetype</u>	<u>Case Disp</u>			<u>Sect</u>	<u>Sur Typ</u>	<u>Sur Num</u>	<u>Suff</u>	<u>Subdivision</u>	<u>Act Pend</u>
293200	PENDING	14	0070N	0030W	017	FF		PORTION OF;	

Serial Number: AZA 035952

Total Case Acres: 1.000

<u>Casetype</u>	<u>Case Disp</u>			<u>Sect</u>	<u>Sur Typ</u>	<u>Sur Num</u>	<u>Suff</u>	<u>Subdivision</u>	<u>Act Pend</u>
380913	AUTHORIZED	14	0070N	0030W	017	FF		SE;	

